



Three ways ball valves, rating PN 63 in stainless steel with PTFE seat.

AT.EX. certified for zone 1 and 21

Available versions

- L port
- T port.

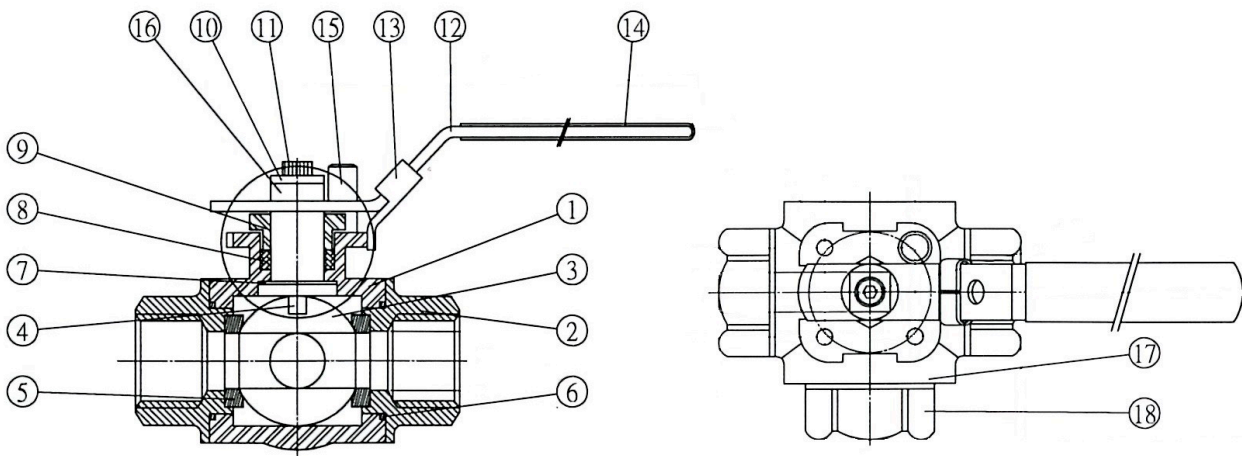

V-3W			
N°	ITEM	MATERIAL	DETAIL
1	BODY	STAINLESS STEEL	ASTM A351 CF8M
2	END CAP	STAINLESS STEEL	ASTM A351 CF8M
3	BALL	STAINLESS STEEL	ASTM A351 CF8M
4	STEM	STAINLESS STEEL	AISI 316
5	SEAT	PTFE	-
6	BODY SEAL	PTFE	-
7	THRUST WASHER	PTFE	-
8	STEM SEAL	PTFE	-
9	GLAND NUT	STAINLESS STEEL	AISI 304
10	WASHER	STAINLESS STEEL	AISI 304
11	HANDLE BOLT	STAINLESS STEEL	AISI 304
12	HANDLE	STAINLESS STEEL	AISI 304
13	LOOK DEVICE (*)	STAINLESS STEEL	AISI 304
14	SLEEVE	PVC	-
15	STOP PIN	STAINLESS STEEL	AISI 304
16	WASHER	STAINLESS STEEL	AISI 304
17	BODY SEAL	STAINLESS STEEL	AISI 304
18	END CAP	STAINLESS STEEL	ASTM A351 CF8M

(*) Optional

Technical details

- Body in stainless steel.
- End caps in stainless steel F/F BSP threaded (standard) or NPT or S.W.
- Three ways reduced bore.
- L port (standard) or T port.
- Seat: PTFE.
- Ball in stainless steel.
- Available sizes from diam. 1/4" to 2".
- Suitable for all directions of fluids.
- Investment casting body and cap.
- Lever operated (optional lock device).
- Upper flange according to ISO 5211.
- Working temperature: -20°C / +160°C.
- Suitable for different kind of fluids and industrial applications.
- AT.EX. Certified for zone 1 and 21.
- Rating PN 63.
- Hydraulic test according to ISO 5208.
- Body test at 95 bar.
- Seat test at 70 bar.

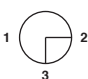
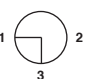
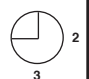
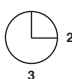
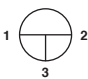
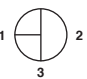
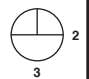
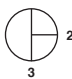
PORT TYPE \	0°	90°	180°	270°
L				
T				

DIMENSIONS

V-3W

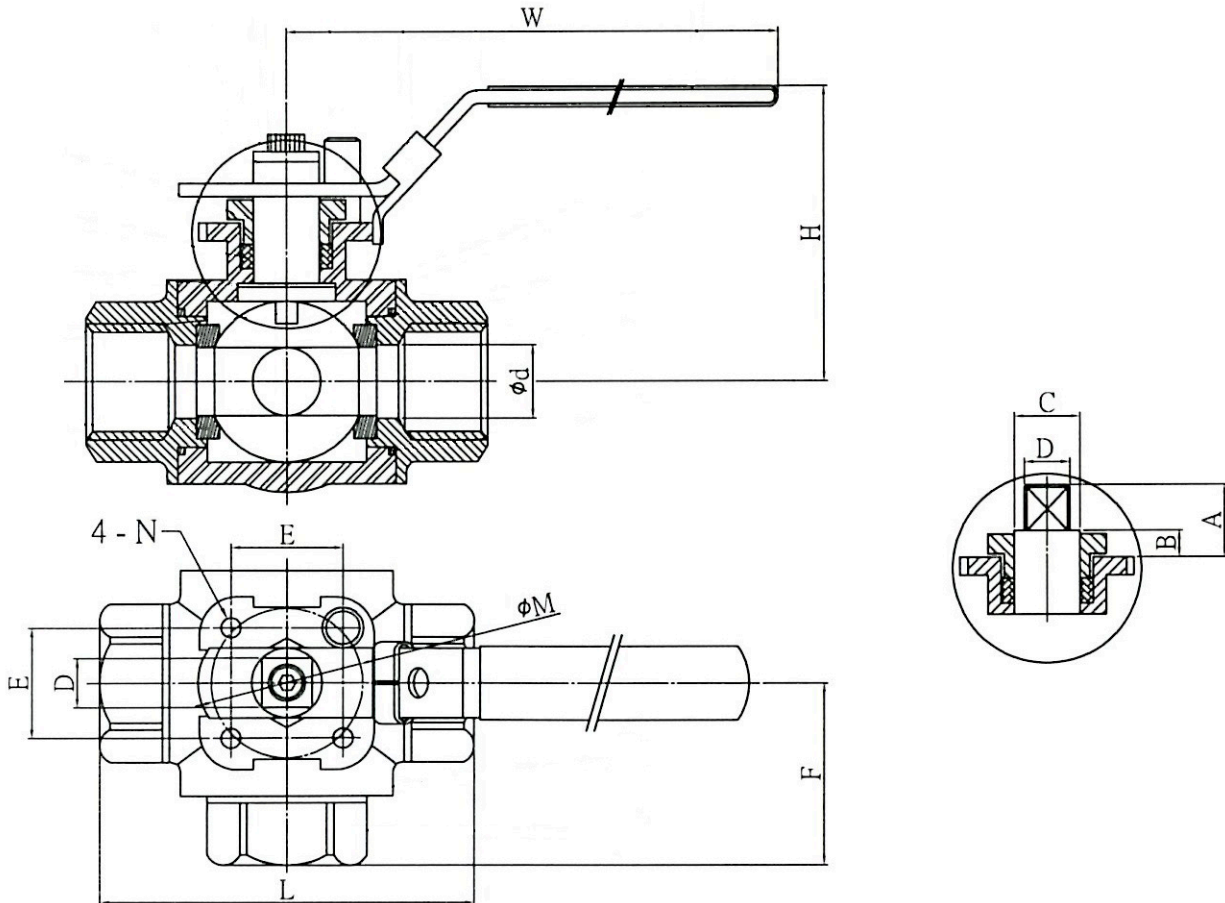

SIZE	ϕd (mm)	L (mm ± 2)	H (mm ± 5)	W (mm)	F (mm ± 2)	A (mm)	B (mm)	C (mm)	D (mm)	E (mm)	ISO 5211		TORQUE (Nm) 1 BAR	WEIGHT (kg)
											ϕM	N		
1/4"	11.0	64	58	140	32	10.0	4.0	12.7	9.0	29.7	42	M5	6.8	0.54
3/8"	11.0	64	58	140	32	10.0	4.0	12.7	9.0	29.7	42	M5	6.8	0.54
1/2"	12.7	75	65	140	36	12.5	6.5	12.7	9.0	29.7	42	M5	10.0	0.67
3/4"	16.0	84	82	188	42	15.5	8.0	15.0	10.7	35.4	50	M6	15.0	1.28
1"	20.0	101	88	188	50	17.0	9.5	15.0	10.7	35.4	50	M6	20.0	1.67
1.1/4"	25.0	119	94	188	59	17.0	9.5	15.0	10.7	35.4	50	M6	35.0	2.37
1.1/2"	32.0	130	100	237	62	19.0	8.0	20.0	14.0	49.5	70	M8	50.0	3.70
2"	38.0	150	108	237	72	19.0	8.0	20.0	14.0	49.5	70	M8	65.0	5.59

PRESSURE/TEMPERATURE

